

FOR LEASE

7,709 SF | Corona, CA | Free-Standing High-Image Office Building

Presented by Strata Realty, Inc. | www.stratarealty.com | T (951) 280-1733 | F (951) 280-1739



7,709 SF FREE-STANDING OFFICE BUILDING

Location

1861 California Avenue
Corona, CA 92881

Features

- Divisible to 2,564 SF and 5,145 SF
- Part of a 10 acre master-planned office park
- Highly upgraded tenant improvements, plug and play space-ready for occupancy
- Dramatic reception area with 14 foot ceiling
- Herculite glass conference room doors
- Four (4) private offices
- Two (2) break rooms with sinks and disposals
- Men's and Women's restrooms
- 4:1 Parking
- Directly across from the South Corona post office and within walking distance to many retail amenities nearby
- Great access to 91 and I-15 freeways

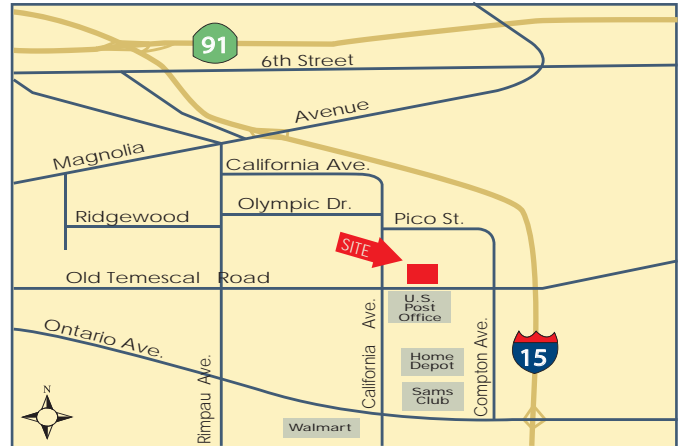

Contact:

Timothy Hawke, SIOR

(951) 280-1733 | thawke@stratarealty.com

Adam Silverman

(951) 280-1733 | asilverman@stratarealty.com

Jason Palda

(951) 280-1733 | jpalda@stratarealty.com

FOR LEASE

7,709 SF | Corona, CA | Free-Standing High-Image Office Building

Contact: Tim Hawke, Adam Silverman, or Jason Palda | T (951) 280-1733

FLOOR PLAN

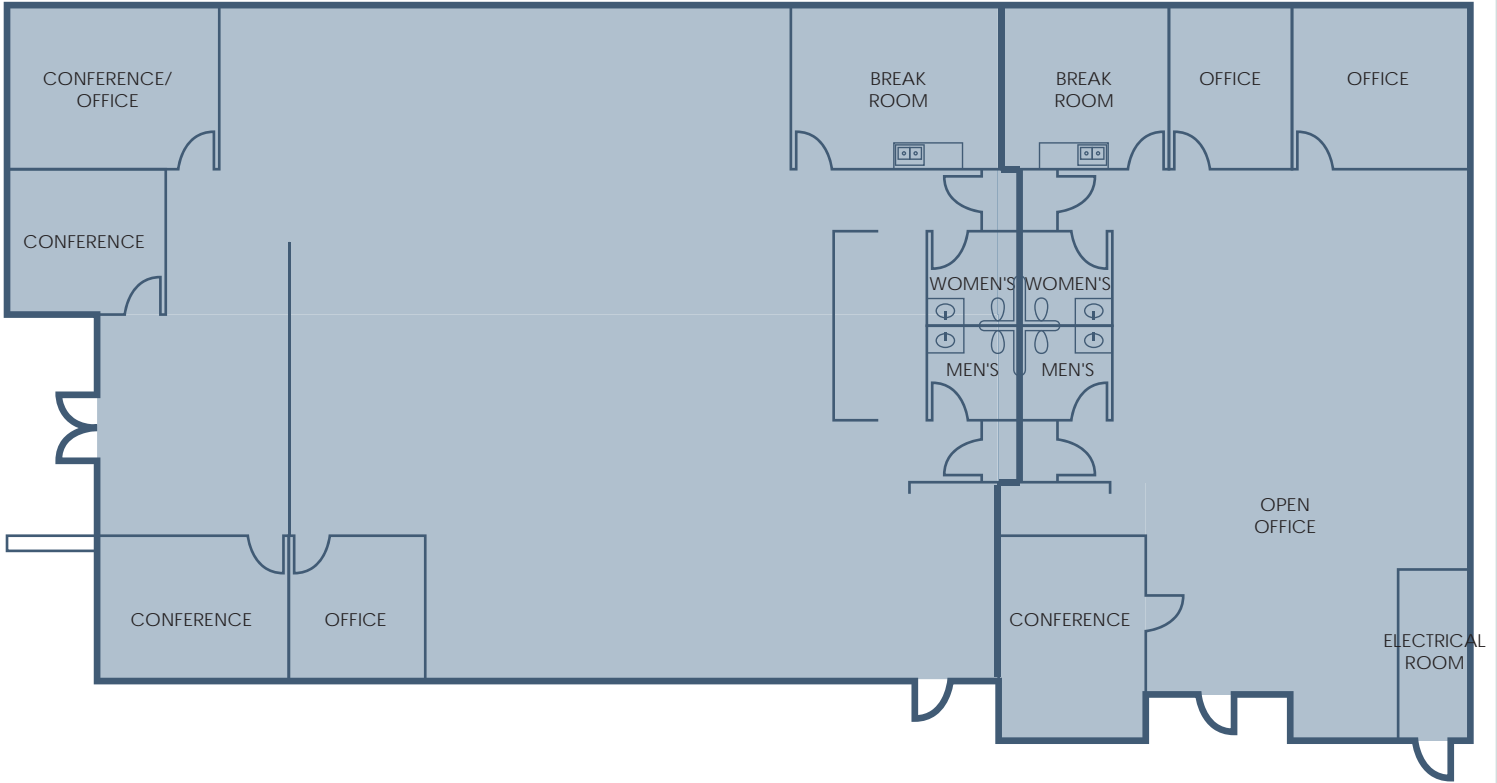

SITE PLAN

